

SMART-BOX TANDEM BOX SERIES

SMART-BOX Smart drawer series



SMART-BOX

Smart drawer series

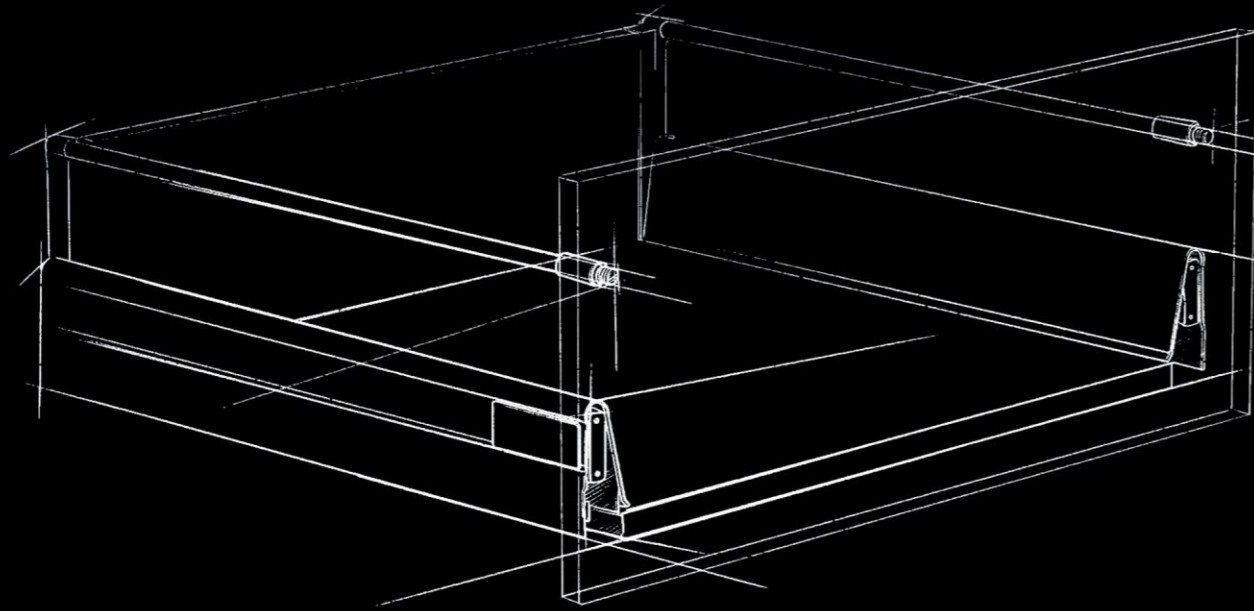

No edges

The shape has no edges and corners, and has its own square circles.
No angular pumping design, the appearance of atmospheric and elegant,
The lines are soft and warm, showing the gentle and inclusive temperament of a home.



SMART-BOX Smart drawer series

Smart drawer series Gr201

DRAWER SERIES



Describe

Concealed Full Extension;
Full extension synchronous suspension orbit technology;
40 kg Load capacity, long service life;
It can be adjusted in three dimensions on the side;
Built-in SCT infinitely variable speed damping technology;
To ensure the slide has smooth and gentle movement;
65kg heavy-duty slide is available;



Space required

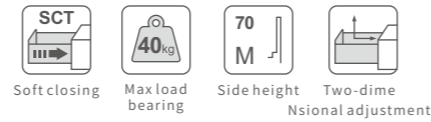
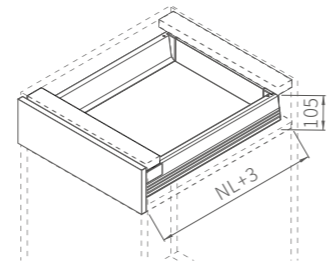

Product information

Smart drawer	Smart drawer		
	Nominal length	Flash silver	Amount
	270	GR201-270	6SET
	300	GR201-300	6SET
	350	GR201-350	6SET
	400	GR201-400	6SET
	450	GR201-450	6SET
	500	GR201-500	6SET
	550	GR201-550	6SET

Contact(Industrial packaging)

1	Slide rail L/R			
	Nominal length	40KG	65KG	Amount
	270	322270		10SET
	300	322300		10SET
	350	322350		10SET
	400	322400		10SET
	450	322450	323450-G	10SET
	500	322500	323500-G	10SET
	550	322550	323550-G	10SET

2	Smart Side Gang L/R		
	Nominal length	Flash silver	Amount
	270	2011270	20PCS
	300	2011300	20PCS
	350	2011350	20PCS
	400	2011400	20PCS
	450	2011450	20PCS
	500	2011500	20PCS
	550	2011550	20PCS

3	Rear Connector L/R	
	Product Code	Amount
	201070	100SET

3	Front Connector	
	Product Code	Amount
	201001	100SET

3	Quick-mounting Front Connector	
	Product Code	Amount
	320001	100SET

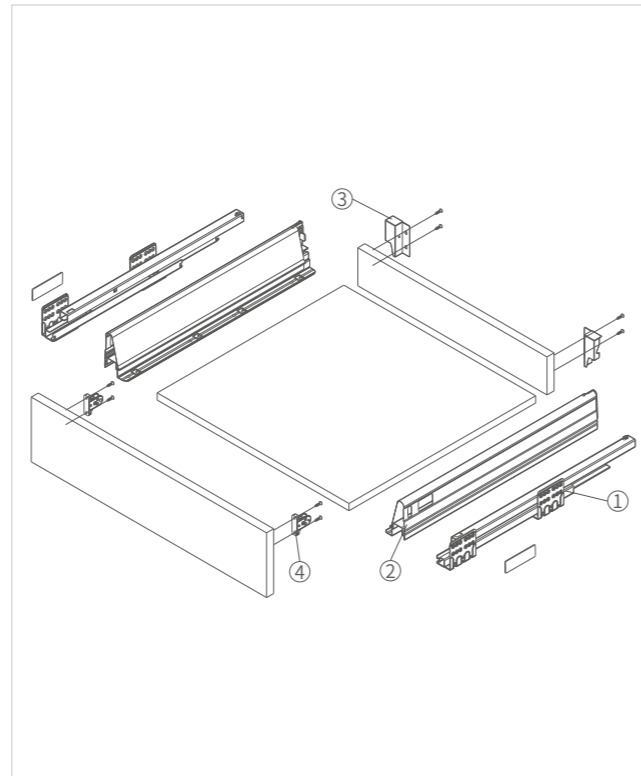

Space requirements of the inner cabinet installation

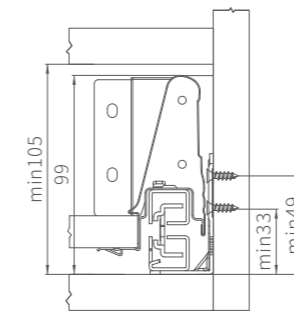

Front Code Panel Mounting Dimensions

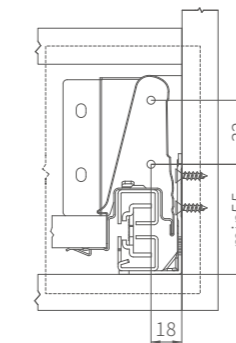

Panel hole size

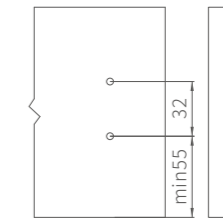

Back-panel mounting size

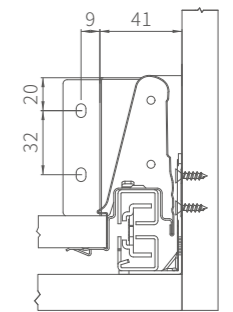

Cabinet slide mounting size

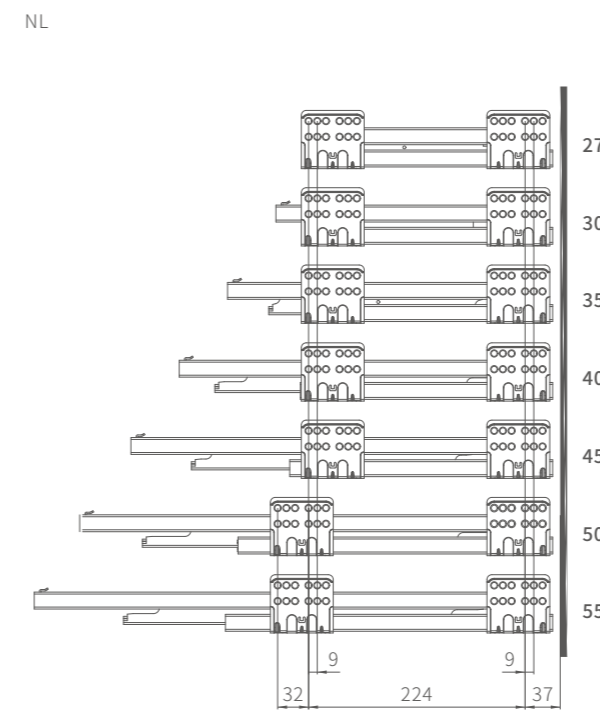

Slide mounting size

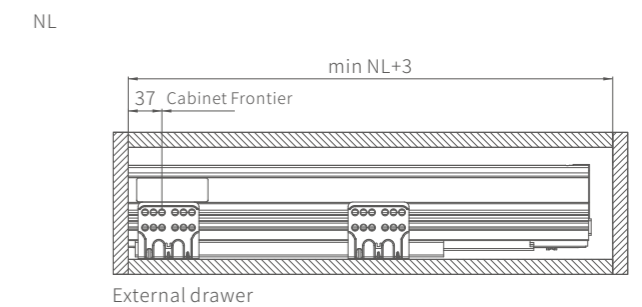

16mm (thickness) MDF cutting size

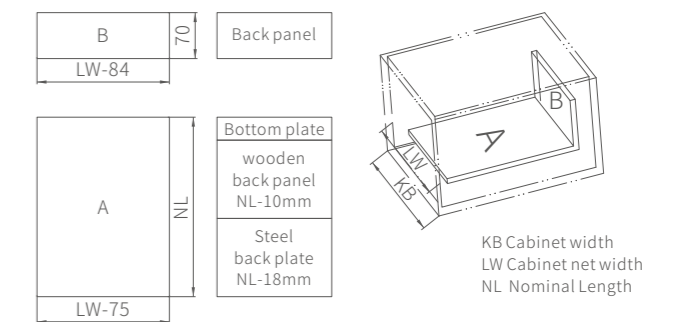

SMART-BOX Smart drawer series

Smart drawer series Gr202

DRAWER SERIES



Describe

Concealed Full Extension;
Full extension synchronous suspension orbit technology;
40 kg Load capacity, long service life;
It can be adjusted in three dimensions on the side;
Built-in SCT infinitely variable speed damping technology;
To ensure the slide has smooth and gentle movement;



Product Details

Space required

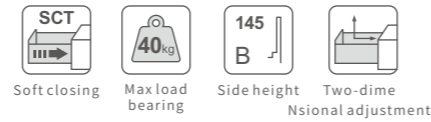
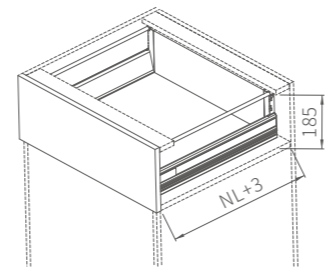

Product information

Smart drawer	Smart drawer		
	Nominal length	Flash silver	Amount
	270	GR202-270	6SET
	300	GR202-300	6SET
	350	GR202-350	6SET
	400	GR202-400	6SET
	450	GR202-450	6SET
	500	GR202-500	6SET
	550	GR202-550	6SET

Contact(Industrial packaging)

1	Slide rail L/R		
	Nominal length	40KG	Amount
	270	322270	10SET
	300	322300	10SET
	350	322350	10SET
	400	322400	10SET
	450	322450	10SET
	500	322500	10SET
	550	322550	10SET

2	Smart Side Gang L/R		
	Nominal length	Flash silver	Amount
	270	2011270	20PCS
	300	2011300	20PCS
	350	2011350	20PCS
	400	2011400	20PCS
	450	2011450	20PCS
	500	2011500	20PCS
	550	2011550	20PCS

2	Round tie rod L/R		
	Nominal length	Flash silver	Amount
	270	2017270	20PCS
	300	2017300	20PCS
	350	2017350	20PCS
	400	2017400	20PCS
	450	2017450	20PCS
	500	2017500	20PCS
	550	2017550	20PCS

3	Rear Connector L/R	
	Product Code	Amount
	202145	100SET

3	Front Connector	
	Product Code	Amount
	201001	100SET

3	Quick-mounting Front Connector	
	Product Code	Amount
	320001	100SET

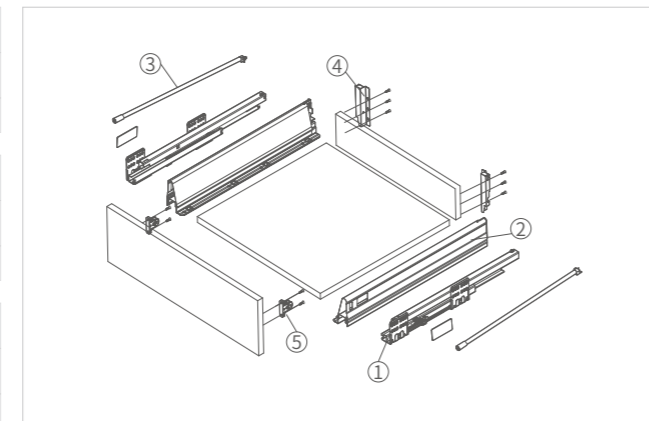

Space requirements of the inner cabinet installation

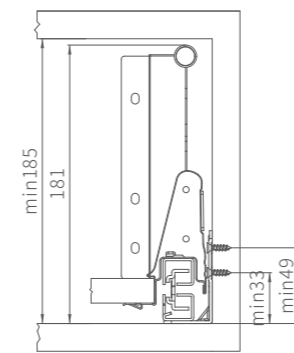

Front Connector panel mounting size

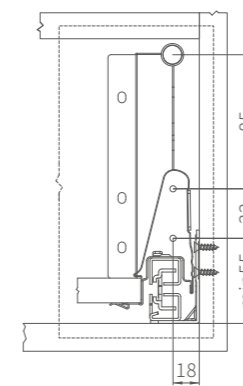

Panel hole size

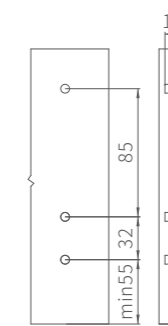

Back-panel mounting size

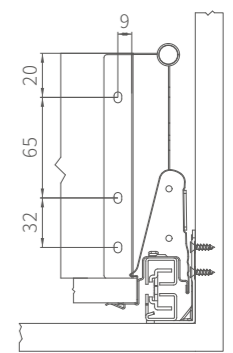

Cabinet slide mounting size

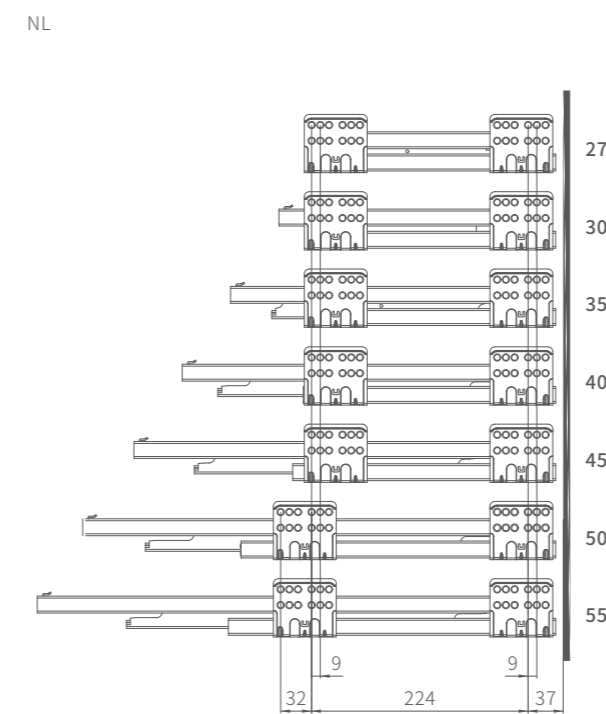

Slide mounting size

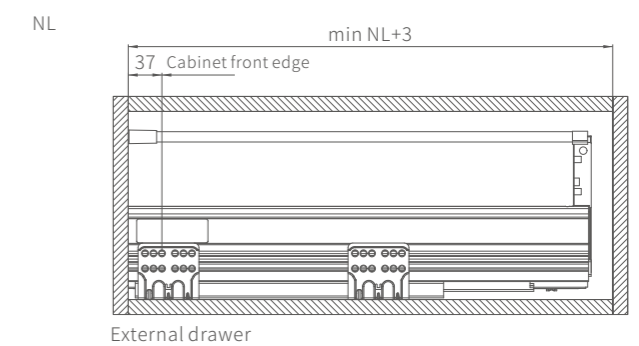

16mm (thickness) MDF cutting size

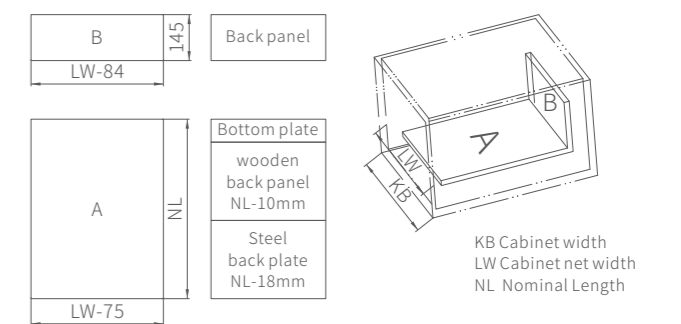

SMART-BOX Smart drawer series

Smart drawer series Gr203

DRAWER SERIES



Describe

Concealed Full Extension;
Full extension synchronous suspension orbit technology;
40 kg Load capacity, long service life;
It can be adjusted in three dimensions on the side;
Built-in SCT infinitely variable speed damping technology;
To ensure the slide has smooth and gentle movement;



Space required

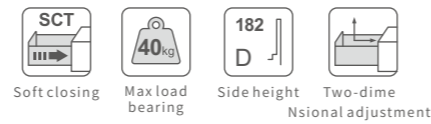
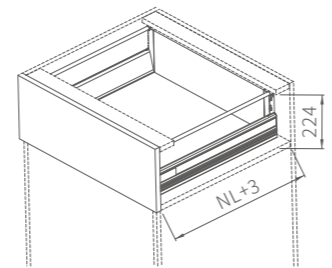

Product information

Smart drawer			
Nominal length	Flash silver	Amount	
270	GR203-270	6SET	
300	GR203-300	6SET	
350	GR203-350	6SET	
400	GR203-400	6SET	
450	GR203-450	6SET	
500	GR203-500	6SET	
550	GR203-550	6SET	

Contact(Industrial packaging)

1 Slide rail L/R			
Nominal length	40KG	Amount	
270	322270	10SET	
300	322300	10SET	
350	322350	10SET	
400	322400	10SET	
450	322450	10SET	
500	322500	10SET	
550	322550	10SET	

2 Smart Side Gang L/R			
Nominal length	Flash silver	Amount	
270	2011270	20PCS	
300	2011300	20PCS	
350	2011350	20PCS	
400	2011400	20PCS	
450	2011450	20PCS	
500	2011500	20PCS	
550	2011550	20PCS	

2 Round tie rod L/R			
Nominal length	Flash silver	Amount	
270	2017270	20PCS	
300	2017300	20PCS	
350	2017350	20PCS	
400	2017400	20PCS	
450	2017450	20PCS	
500	2017500	20PCS	
550	2017550	20PCS	

3 Rear Connector L/R		
Product Code	Amount	
202182	100SET	

3 Front Connector		
Product Code	Amount	
201001	100SET	

3 Shop Quick-mounting Front Connector		
Product Code	Amount	
320001	100SET	

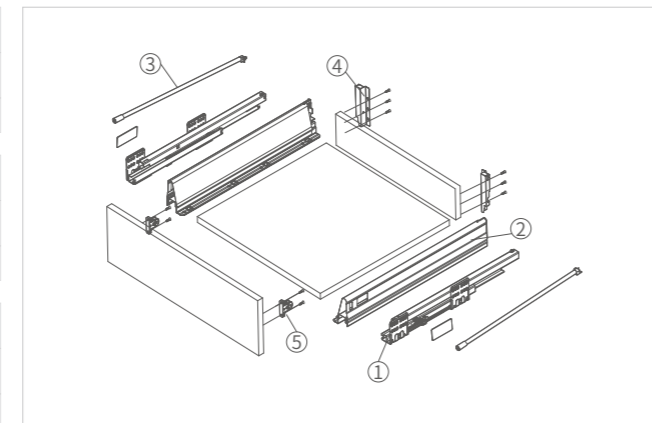

Space requirements of the inner cabinet installation

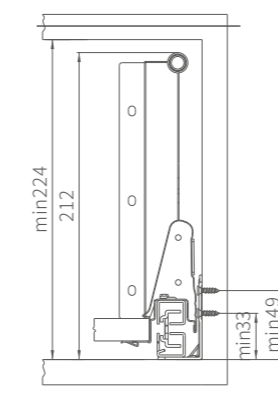

Front Connector panel mounting size

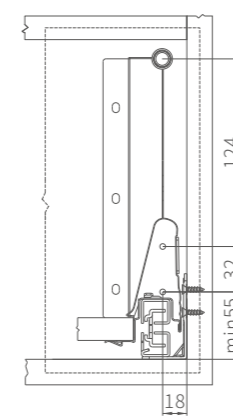

Panel hole size

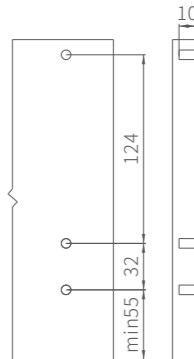

Back-panel mounting size

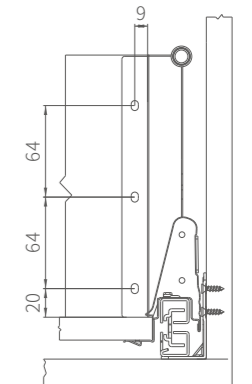

Cabinet slide mounting size

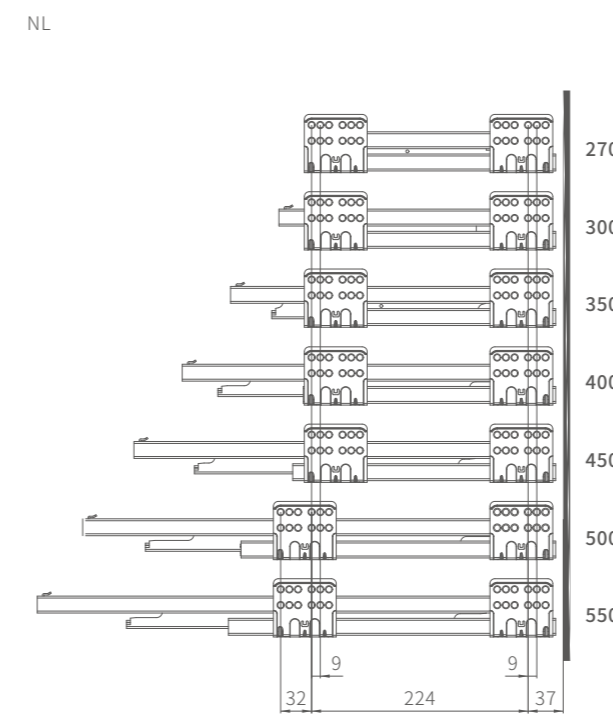

Slide mounting size

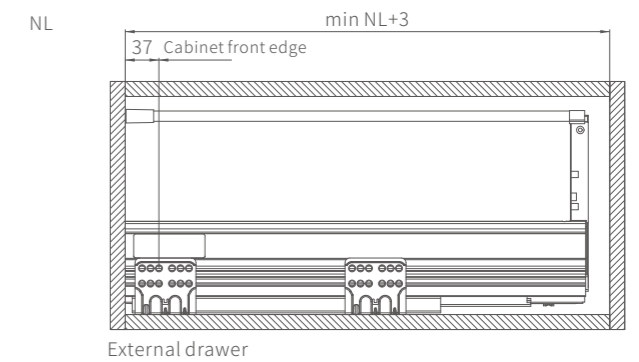

16mm (thickness) MDF cutting size

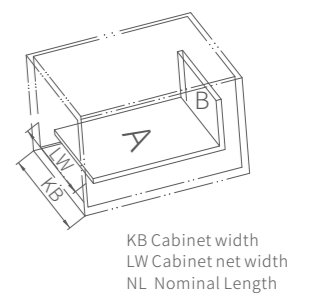
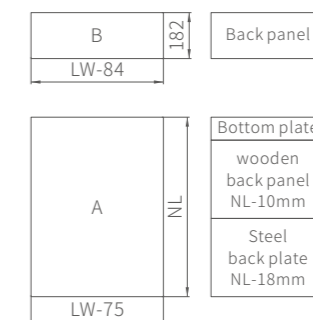

SMART-BOX Smart drawer series

Inner drawer series

DRAWER SERIES



Describe

Concealed Full Extension;
Full extension synchronous suspension orbit technology;
40 kg Load capacity, long service life;
It can be adjusted in three dimensions on the side;
Built-in SCT infinitely variable speed damping technology;
To ensure the slide has smooth and gentle movement;



Space required

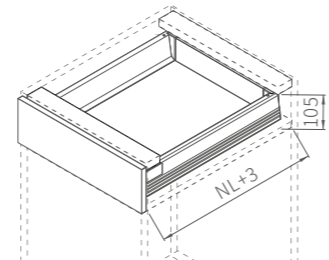

Product information

1	Inner Box panel L/R		
	Nominal length	Flash silver	Amount
	600	20130600	20PCS
	800	20130800	20PCS
	900	20130900	20PCS
	1000	20131000	20PCS
	1200	20131200	20PCS

2	Inner Box Front Connector L/R	
	Product Code	Amount
	201301	100SET

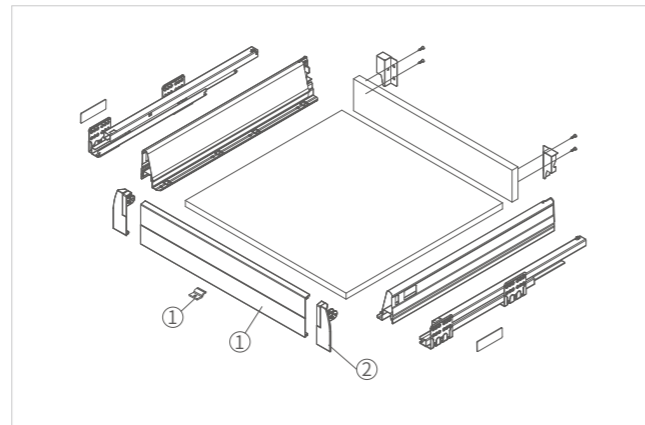

Space requirements of the inner cabinet installation

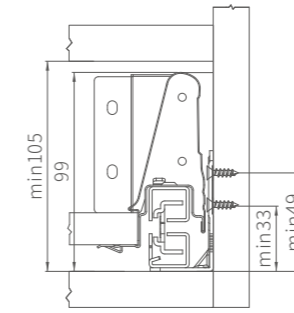

Front Connector panel mounting size

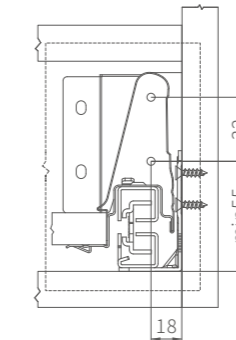

Panel hole size

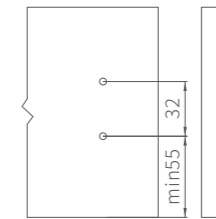

Back-panel mounting size

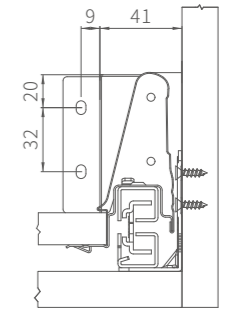

Cabinet slide mounting size

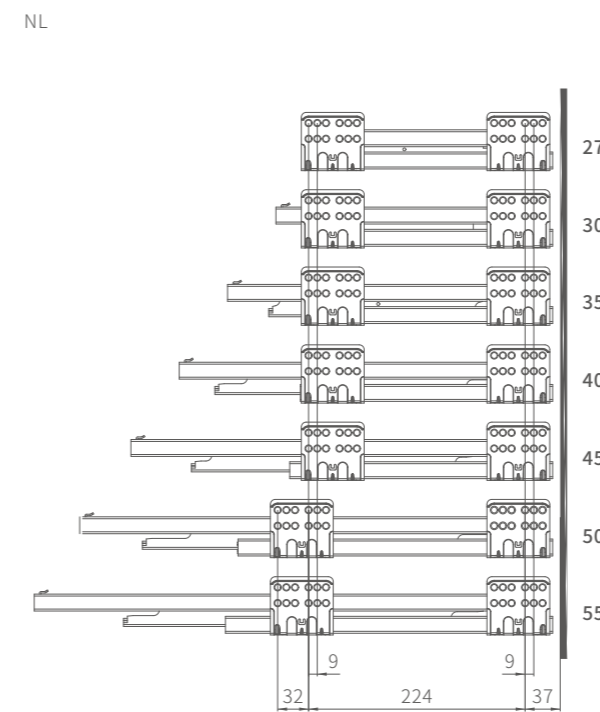

Slide mounting size

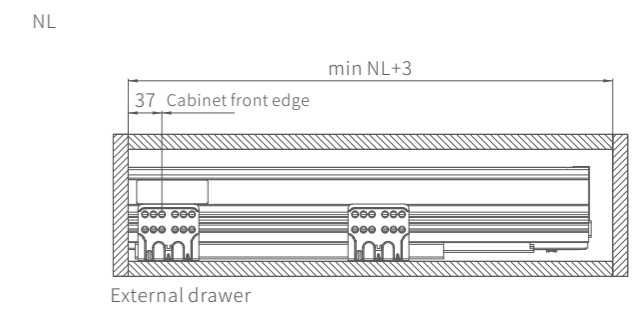

16mm (thickness) MDF cutting size

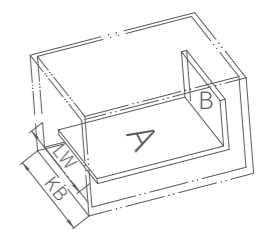
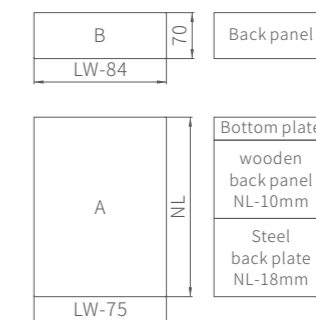

KB Cabinet width
LW Cabinet net width
NL Nominal Length

SMART-BOX Smart drawer series

Inner drawer series

DRAWER SERIES



Describe

Concealed Full Extension;
Full extension synchronous suspension orbit technology;
40 kg Load capacity, long service life;
It can be adjusted in three dimensions on the side;
Built-in SCT infinitely variable speed damping technology;
To ensure the slide has smooth and gentle movement;



Space required

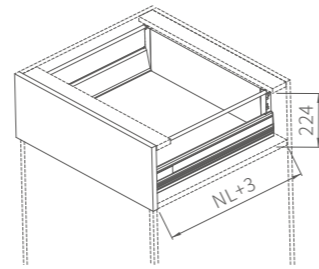

Product information

1	Inner Box panel L/R		
	Nominal length	Flash silver	Amount
	600	20130600	20PCS
	1200	20131200	20PCS

2	Round tie rod L/R		
	Nominal length	Flash silver	Amount
	600	20130600	20PCS
	1200	20131200	20PCS

3	Inner Box Front Connector L/R	
	Product Code	Amount
	201301	100SET

4	Handle	
	Product Code	Amount
	201301	100SET

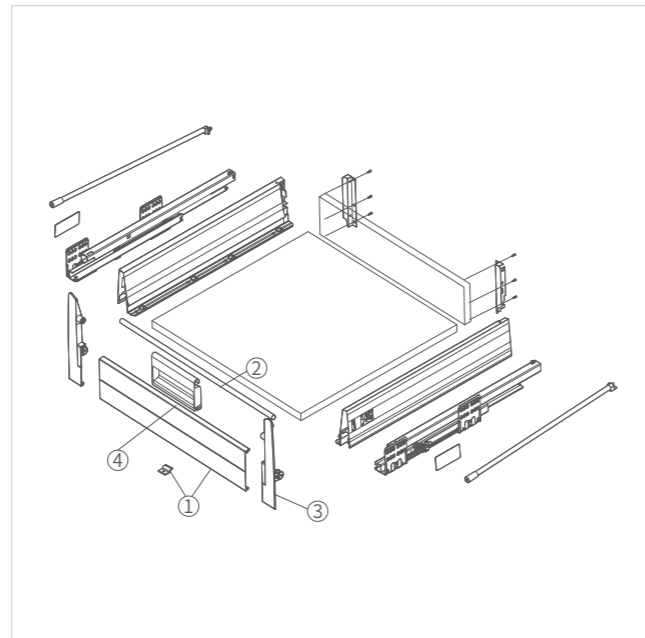

Space requirements of the inner cabinet installation

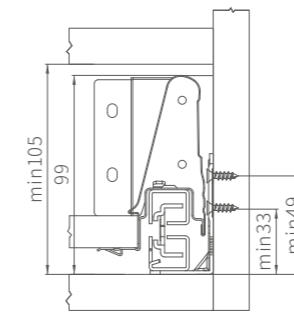

Front Connector panel mounting size

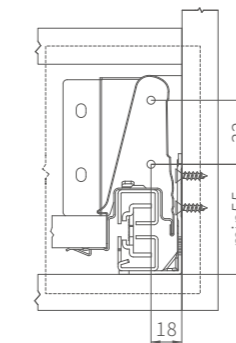

Panel hole size

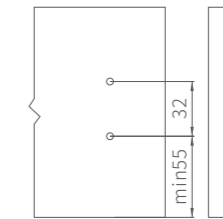

Back-panel mounting size

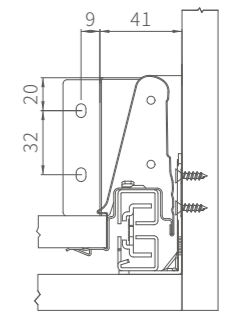

Cabinet slide mounting size

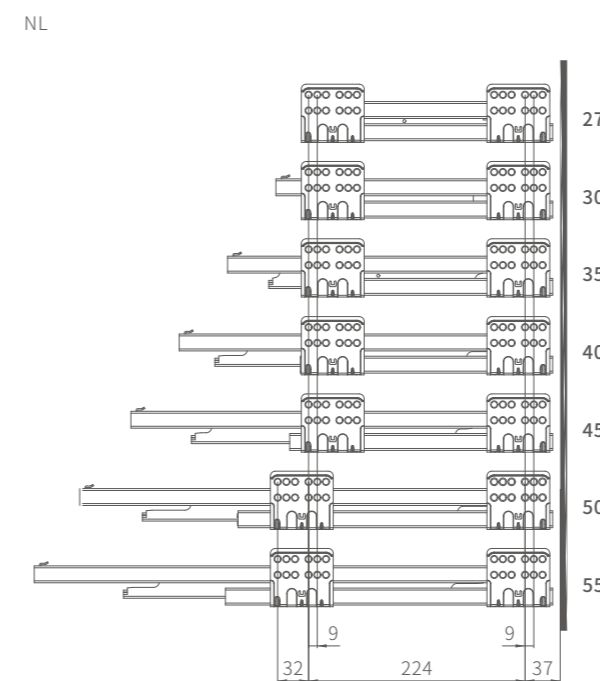

Slide mounting size

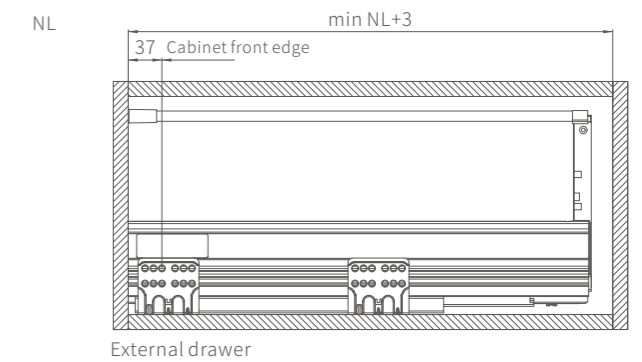

16mm (thickness) MDF cutting size

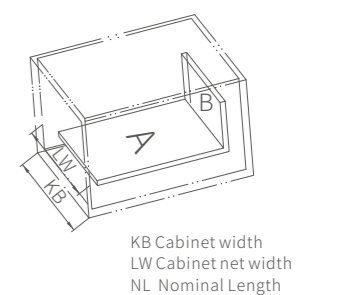
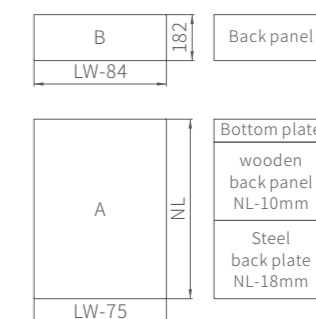



Describe

Stainless Steel cutlery box can have a long time use;
 Can be washed in the dishwasher;
 The inner box can also be flexibly adjusted;
 It can also be used flexibly for special cabinet widths;
 Suitable for lower-part drawers;
 The design is stylish and simple, we guarantee its durability;
 The material is imported 304 stainless steel;



Product Details

Product information

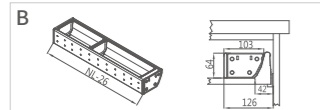

Nominal length	Product Code
400	GRB400B
450	GRB450B
500	GRB500B
550	GRB550B

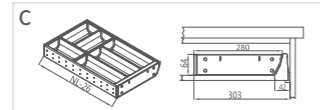

Nominal length	Product Code
400	GRB400C
450	GRB450C
500	GRB500C
550	GRB550C

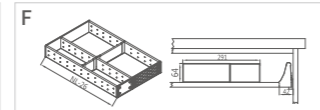

Nominal length	Product Code
400	GRB400F
450	GRB450F
500	GRB500F
550	GRB550F

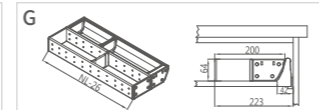

Nominal length	Product Code
400	GRB400G
450	GRB450G
500	GRB500G
550	GRB550G

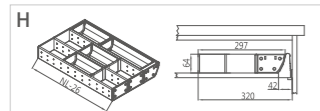

Nominal length	Product Code
400	GRB400H
450	GRB450H
500	GRB500H
550	GRB550H

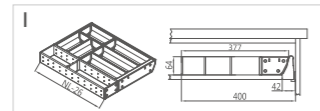

Nominal length	Product Code
400	GRB400I
450	GRB450I
500	GRB500I
550	GRB550I

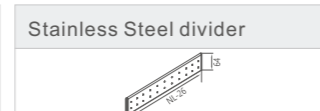

Nominal length	Product Code
400	GRB070H-400
450	GRB070H-450
500	GRB070H-500
550	GRB070H-550



Nominal length	Product Code
88×88	GRB010S
88×176	GRB020S
88×264	GRB030S

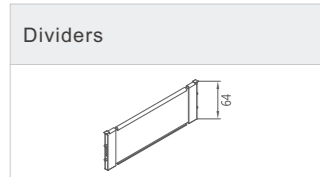

Size	Product Code
122-150	GRB011Q

Can be used for the overall connection of 600-800 drawers

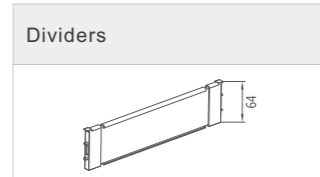

Size	Product Code
242-270	GRB012Q

Can be used for the overall connection of 900 drawers

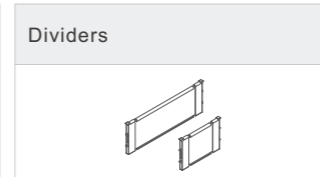

Size	Product Code
88×64	GRB050Q
176×64	GRB060Q

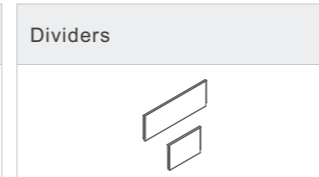

Size	Product Code
88×64	GRB080Q
176×64	GRB090Q



Cabinet net width:270/300mm	
Nominal length	Product Code
400	1×GRB400B
450	1×GRB450B
500	1×GRB500B
550	1×GRB550B



Cabinet net width:300/350mm	
Nominal length	Product Code
400	2×GRB400B
450	2×GRB450B
500	2×GRB500B
550	2×GRB550B



Cabinet net width:400/450/500mm	
Nominal length	Product Code
400	1×GRB400C
450	1×GRB450C
500	1×GRB500C
550	1×GRB550C



Cabinet net width:600mm	
Nominal length	Product Code
400	1×GRB400C+1×GRB400B
450	1×GRB450C+1×GRB450B
500	1×GRB500C+1×GRB500B
550	1×GRB550C+1×GRB550B

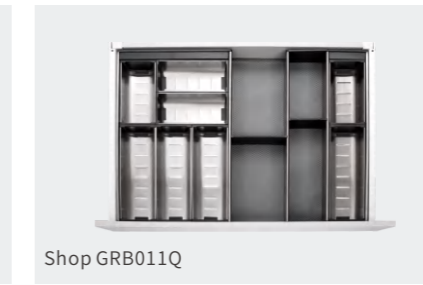

Cabinet net width:700mm	
Nominal length	Product Code
400	1×GRB400C+1×GRB400G
450	1×GRB450C+1×GRB450G
500	1×GRB500C+1×GRB500G
550	1×GRB550C+1×GRB550G



Cabinet net width:800mm	
Nominal length	Product Code
400	2×GRB400C
450	2×GRB450C
500	2×GRB500C
550	2×GRB550C



Cabinet net width:900/1000mm	
Nominal length	Product Code
400	1×GRB400I+1×GRB400C
450	1×GRB450I+1×GRB450C
500	1×GRB500I+1×GRB500C
550	1×GRB550I+1×GRB550C



Cabinet net width:1200mm	
Nominal length	Product Code
400	2×GRB400C+1×GRB400F
450	2×GRB450C+1×GRB450F
500	2×GRB500C+1×GRB500F
550	2×GRB550C+1×GRB550F



Describe

Stainless Steel cutlery box can have a long time use;
 Can be washed in the dishwasher;
 The inner box can also be flexibly adjusted;
 It can also be used flexibly for special cabinet widths;
 Suitable for lower-part drawers;
 The design is stylish and simple, we guarantee its durability;
 The material is imported 304 stainless steel;



Product Details

Product information

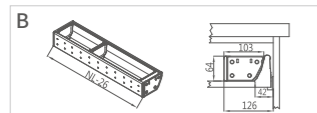

Nominal length	Product Code
400	GRB400B
450	GRB450B
500	GRB500B
550	GRB550B

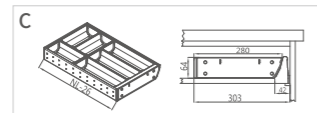

Nominal length	Product Code
400	GRB400C
450	GRB450C
500	GRB500C
550	GRB550C

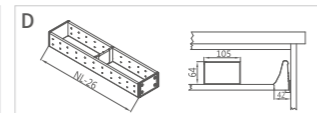

Nominal length	Product Code
400	GRB400D
450	GRB450D
500	GRB500D
550	GRB550D

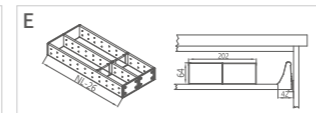

Nominal length	Product Code
400	GRB400E
450	GRB450E
500	GRB500E
550	GRB550E

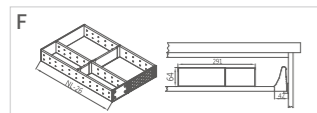

Nominal length	Product Code
400	GRB400F
450	GRB450F
500	GRB500F
550	GRB550F

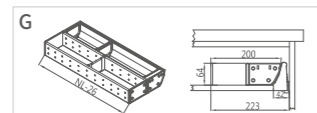

Nominal length	Product Code
400	GRB400G
450	GRB450G
500	GRB500G
550	GRB550G

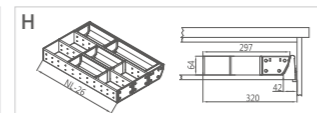

Nominal length	Product Code
400	GRB400H
450	GRB450H
500	GRB500H
550	GRB550H

Stainless steel divider

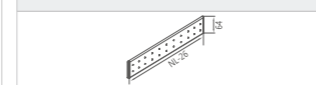

Nominal length	Product Code
400	GRB070H-400
450	GRB070H-450
500	GRB070H-500
550	GRB070H-550

Dividers

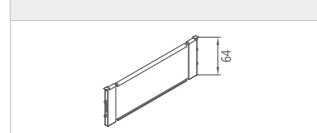

Size	Product Code
122-150	GRB011Q

Can be used for the overall connection of 600-800 drawers

Dividers

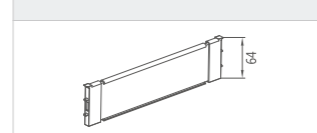

Size	Product Code
242-270	GRB012Q

Can be used for the overall connection of 900 drawers

Dividers

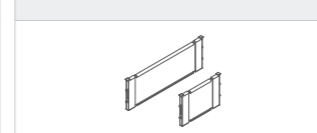

Size	Product Code
88×64	GRB050Q
176×64	GRB060Q

Dividers

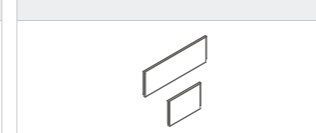

Size	Product Code
88×64	GRB080Q
176×64	GRB090Q

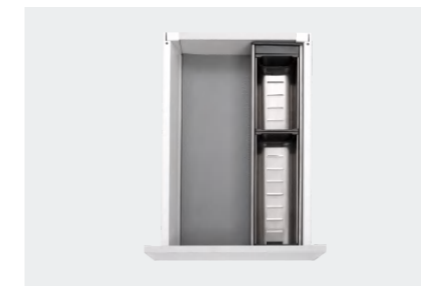

Cabinet net width:270/300mm

Nominal length	Product Code
400	1×GRB400B
450	1×GRB450B
500	1×GRB500B
550	1×GRB550B



Cabinet net width:300/400mm

Nominal length	Product Code
400	1×GRB400D
450	1×GRB450D
500	1×GRB500D
550	1×GRB550D



Cabinet net width:400/450/500mm

Nominal length	Product Code
400	1×GRB400E
450	1×GRB450E
500	1×GRB500E
550	1×GRB550E

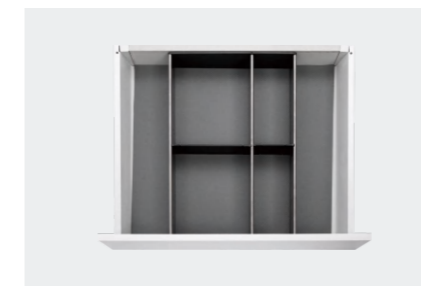

Cabinet net width:600mm

Nominal length	Product Code
400	1×GRB400F
450	1×GRB450F
500	1×GRB500F
550	1×GRB550F



Cabinet net width:800mm

Nominal length	Product Code
400	1×GRB400F+1×GRB400G
450	1×GRB450F+1×GRB450G
500	1×GRB500F+1×GRB500G
550	1×GRB550F+1×GRB550G

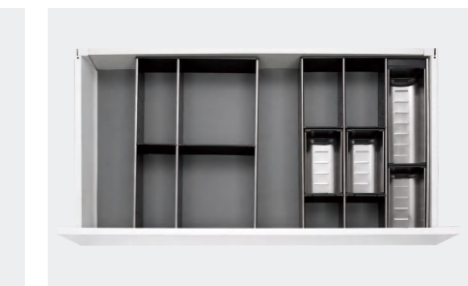

Cabinet net width:900/1000mm

Nominal length	Product Code
400	1×GRB400F+1×GRB400H
450	1×GRB450F+1×GRB450H
500	1×GRB500F+1×GRB500H
550	1×GRB550F+1×GRB550H



Cabinet net width:1200mm

Nominal length	Product Code
400	1×GRB400C+1×GRB400F++1×GRB400H
450	1×GRB450C+1×GRB450F++1×GRB450H
500	1×GRB500C+1×GRB500F++1×GRB500H
550	1×GRB550C+1×GRB550F++1×GRB550H



Product Code	Packing quantity	Kb cabinet net width	The amount of Plate Holder
GR2361	10PCS	400-600MM	2PCS
		800-900MM	4PCS
		1000-1200MM	

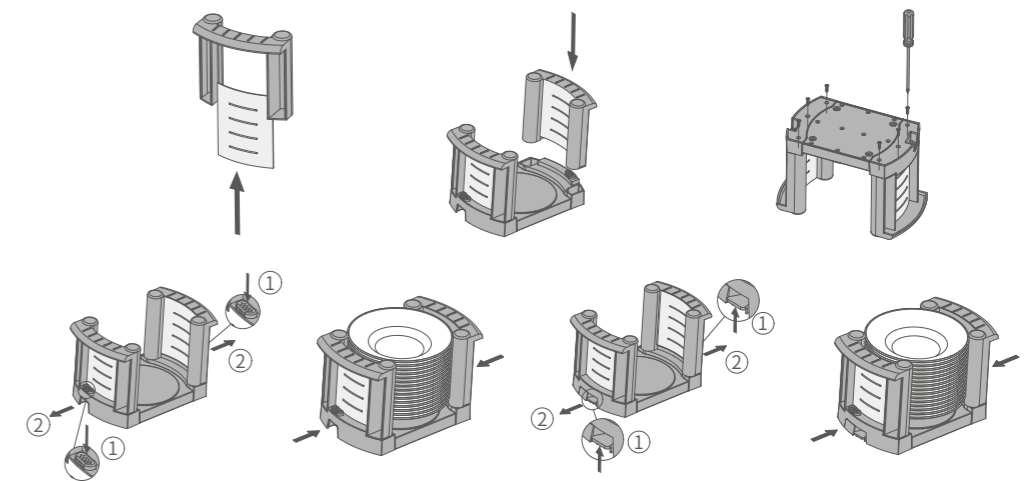

Panel mounting

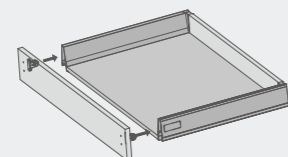
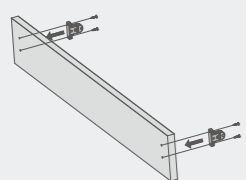

Panel removal

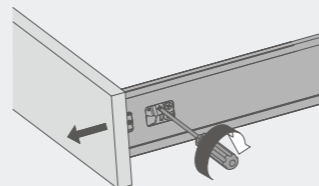
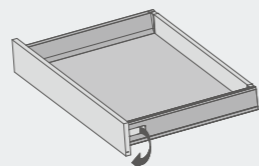

Drawer Installation

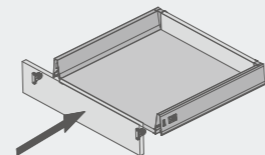
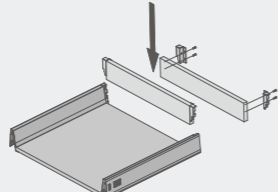
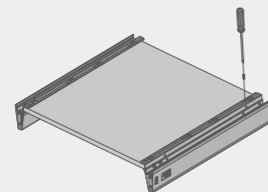
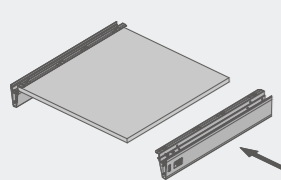

Adjustment

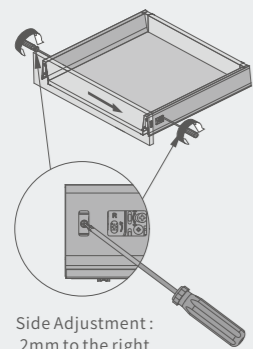

Side Adjustment :
2mm to the right

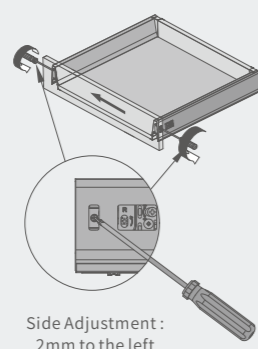

Side Adjustment :
2mm to the left

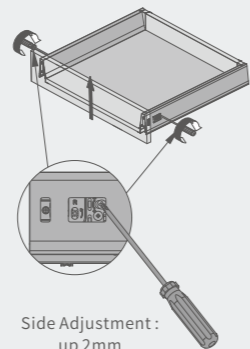

Side Adjustment :
up 2mm

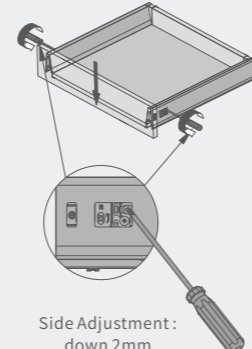

Side Adjustment :
down 2mm

Locking and removal

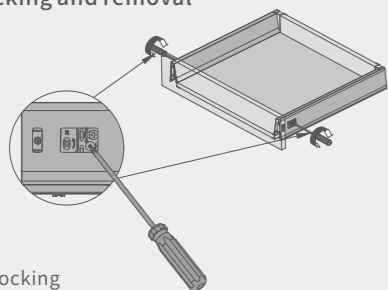

Locking

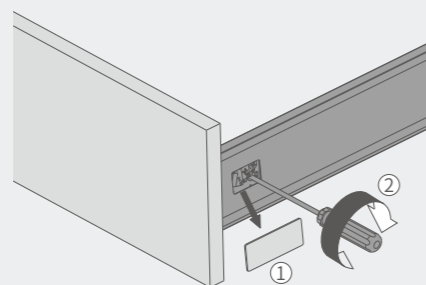

Removal

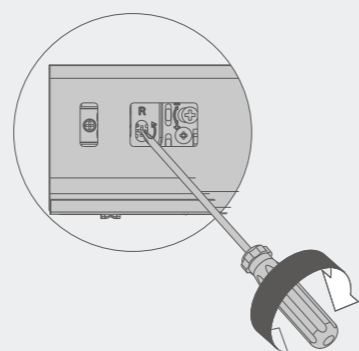

Drawer assembly and removal

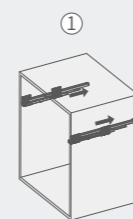

Installation

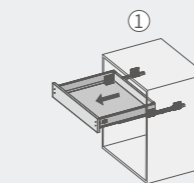
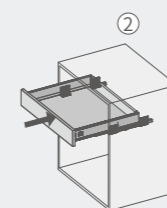

Disassembly

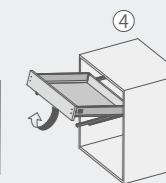
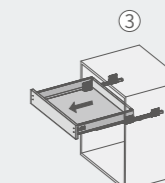
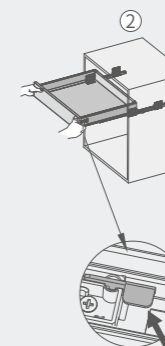

Internal panel mounting

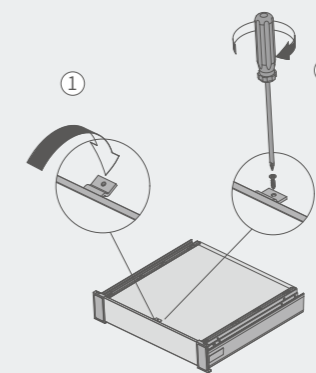
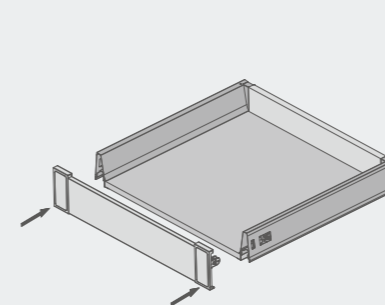
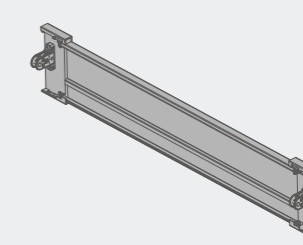
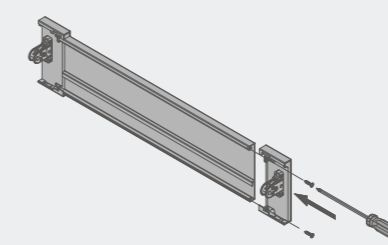
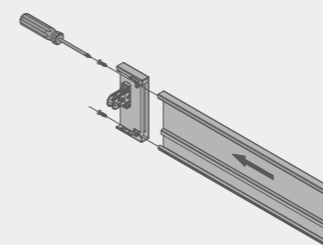

Fixings
Applicable width: cabinet body above 600mm

Panel mounting

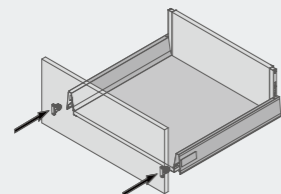
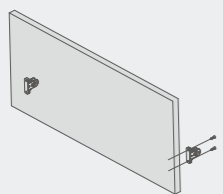

Panel removal

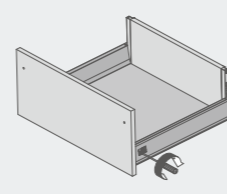
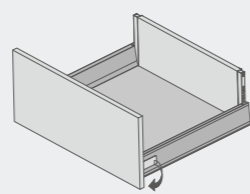

Drawer Installation

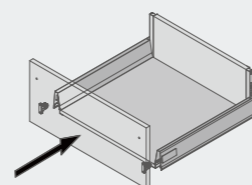
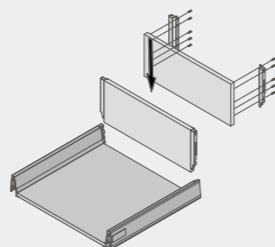
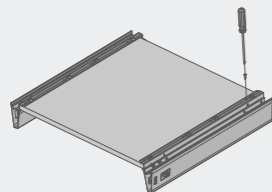
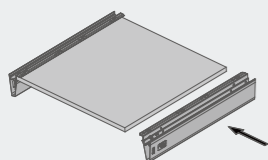

Adjustment

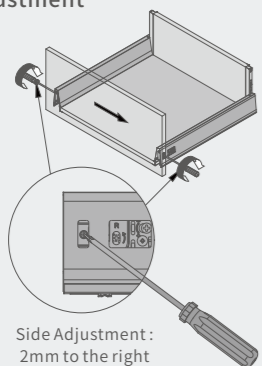

Side Adjustment :
2mm to the right

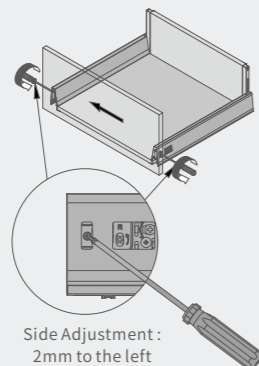

Side Adjustment :
2mm to the left

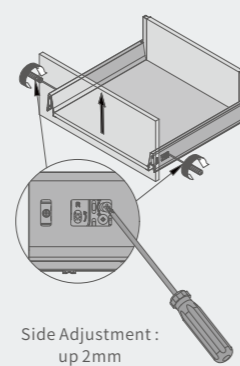

Side Adjustment :
up 2mm

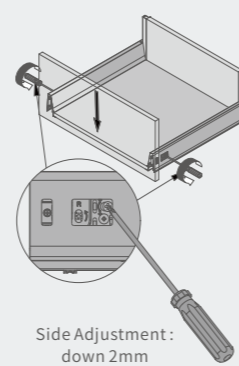

Side Adjustment :
down 2mm

Locking and removal

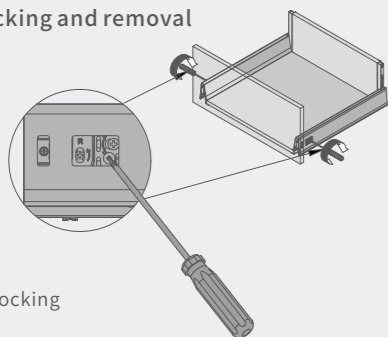

Locking

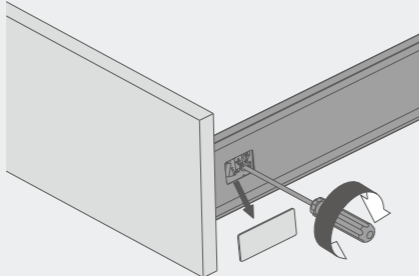

Removal

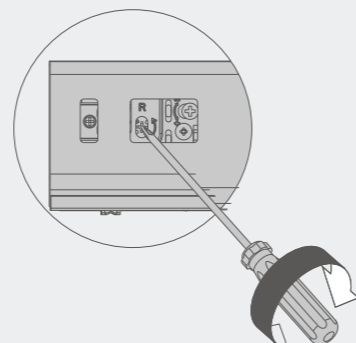

Drawer assembly and removal

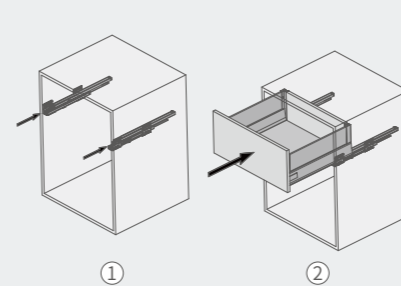

①

②

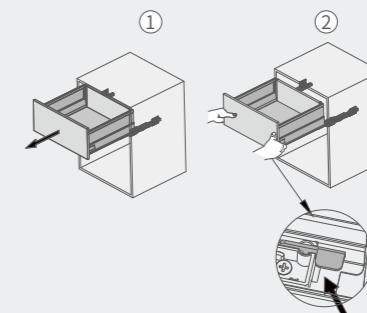

①

②

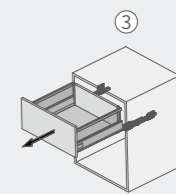

③

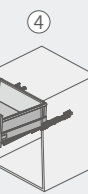

④

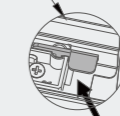

Higher Square bar mounting

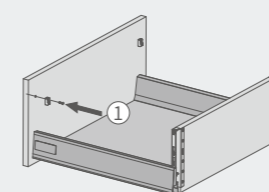

①

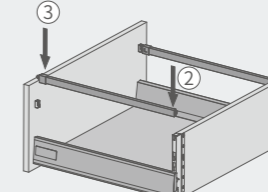

③

②

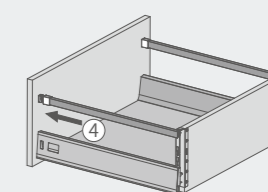

④

Higher round bar mounting

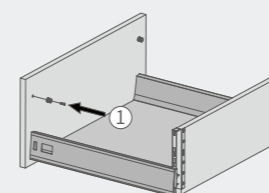

①

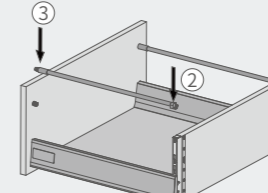

③

②

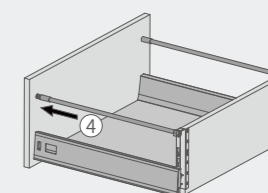

④

Higher side panel mounting

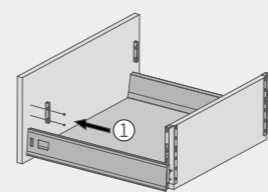

①

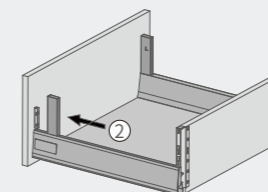

②

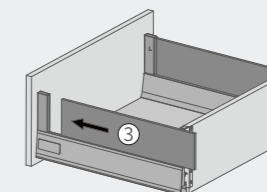

③

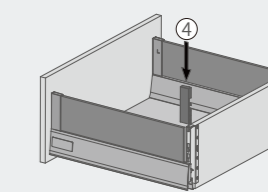

④

Square bar and higher side panel mounting

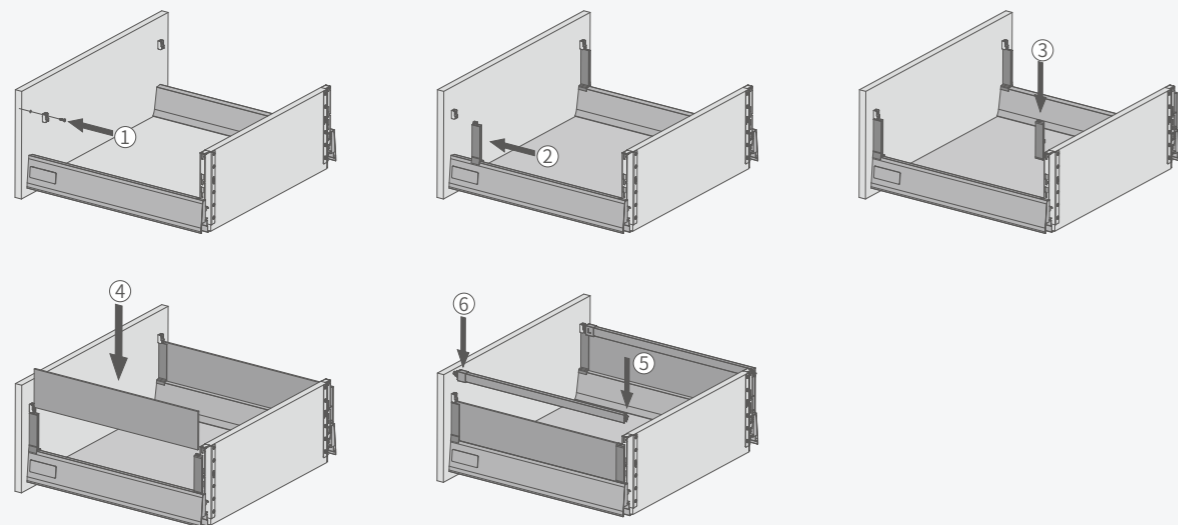

High side inner box drawer with higher side panel mounting

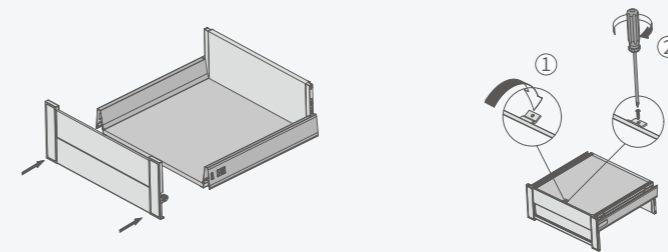

C horizontal partition mounting

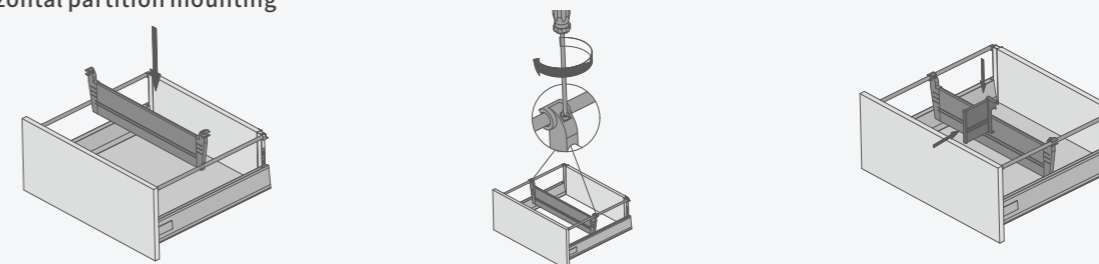

With handrail mounting

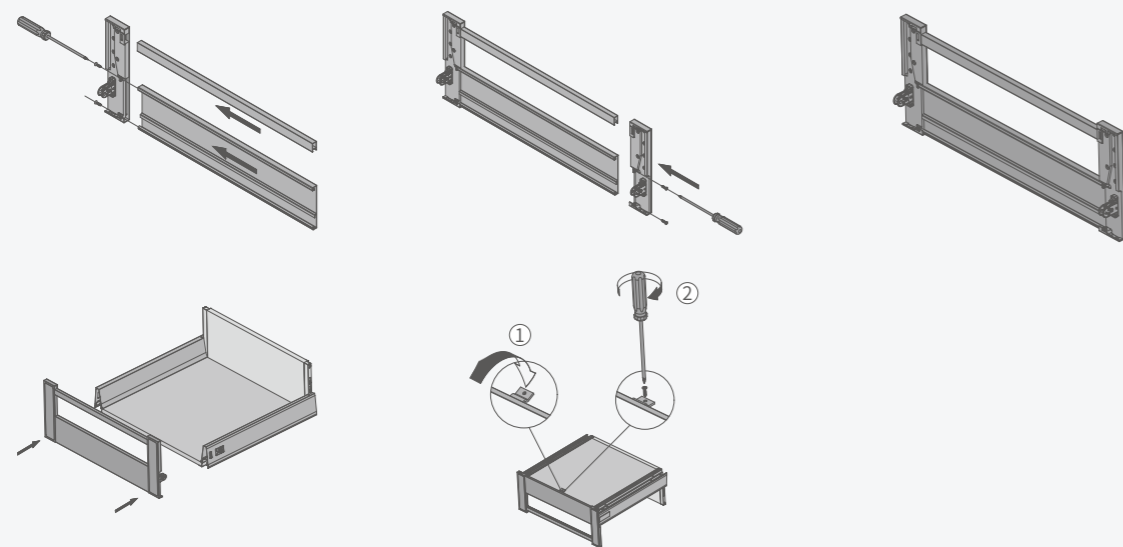

GR cross partition mounting

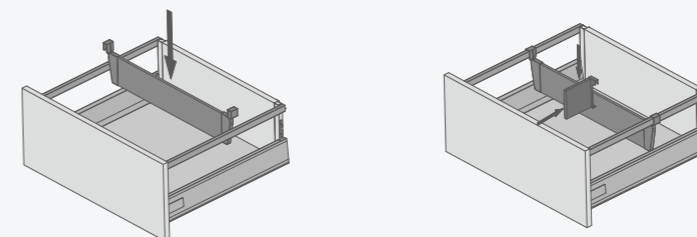

GH cross partition mounting

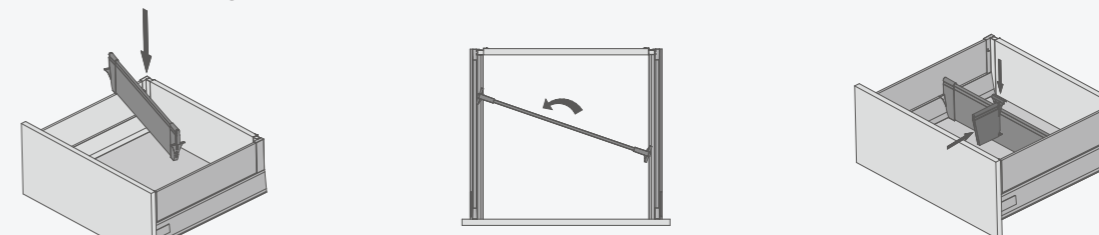

High side inner box drawer with higher side panel mounting

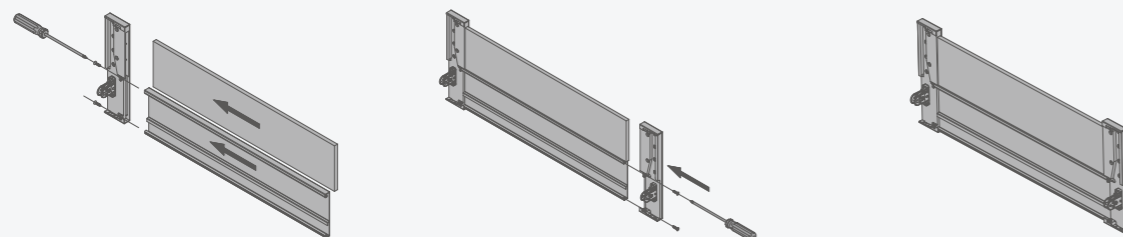

Sink drawer

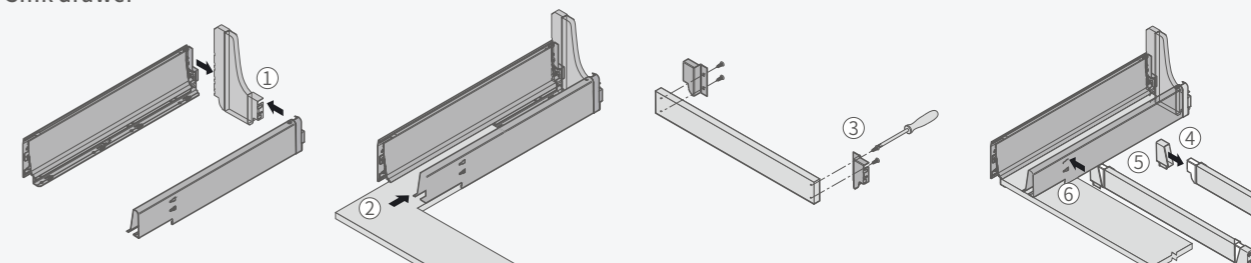

Panel mounting

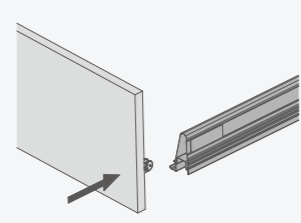
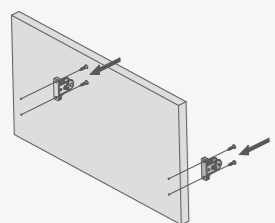

Panel removal

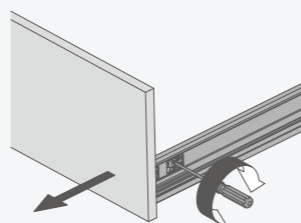
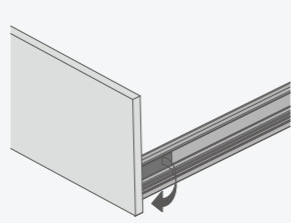

Drawer Installation

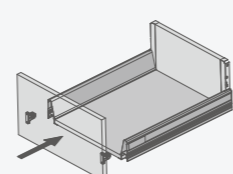
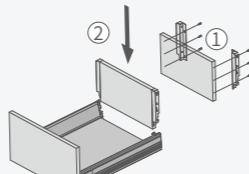
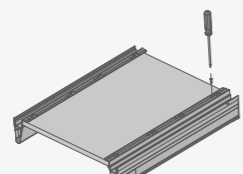
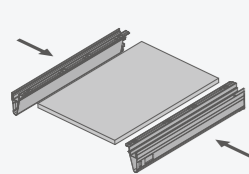

Adjustment

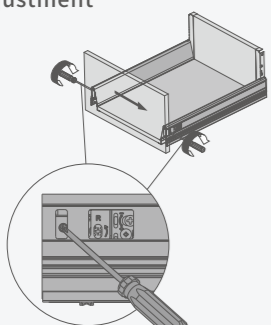

Side Adjustment :
2mm to the right

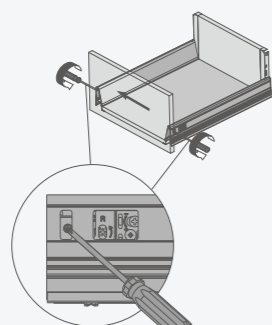

Side Adjustment :
2mm to the left

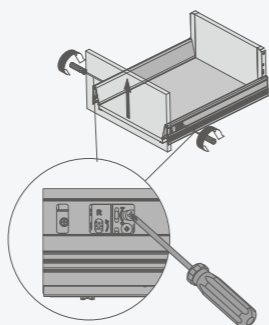

Side Adjustment :
up 2mm

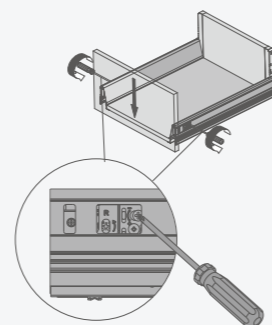

Side Adjustment :
down 2mm

Locking and removal

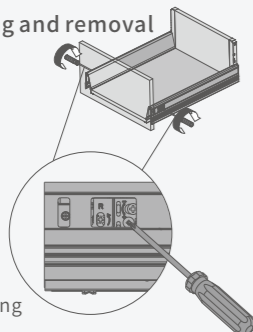

Locking

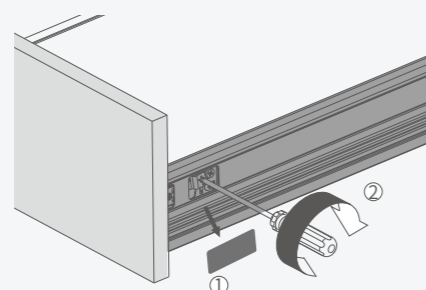

Removal

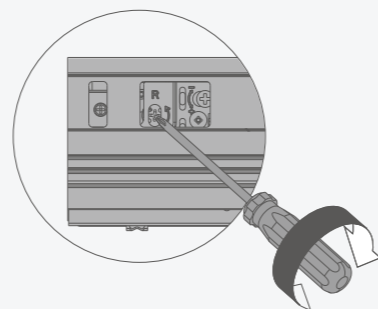

Drawer assembly and removal

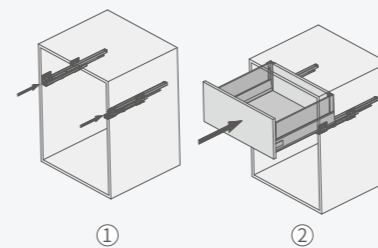

①

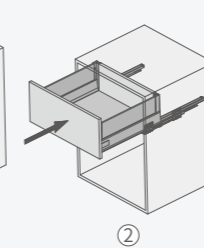

②

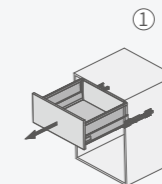

③

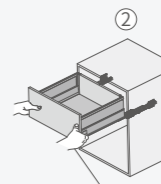

④

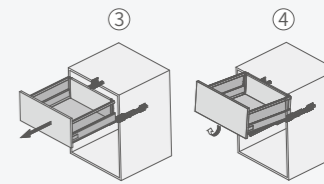

⑤

Internal panel mounting

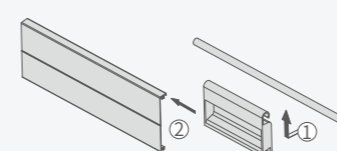

①

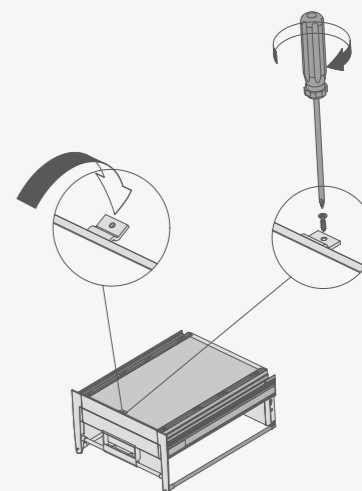
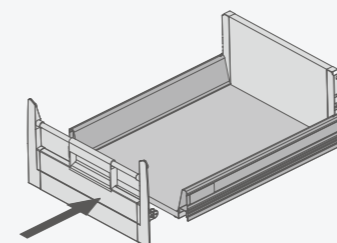
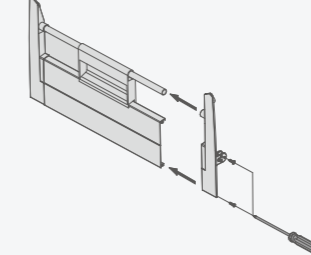

Internal high draw plus high pole mounting

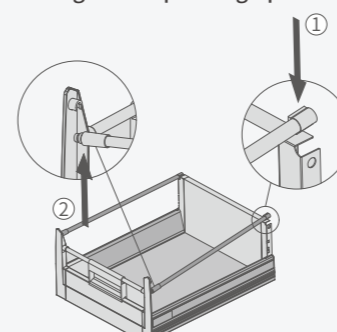

①

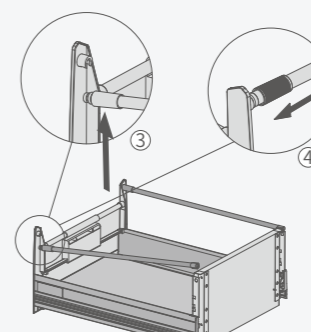

②

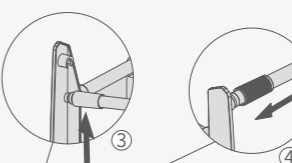

③

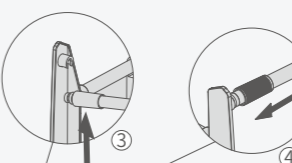

④